

Rail Section Assembly Guide

1. Prepare a suitable working area large enough to assemble each 6' rail section. This area should be a horizontal work surface that is free from any debris that may scratch the painted rail components.
2. Remove the contents of one carton only. Arrange the rail ribbons and balusters (pickets) on the elevated work surface with the handrail ribbon facing front as illustrated below. The short end of the ribbon should be on the right hand side of the table.

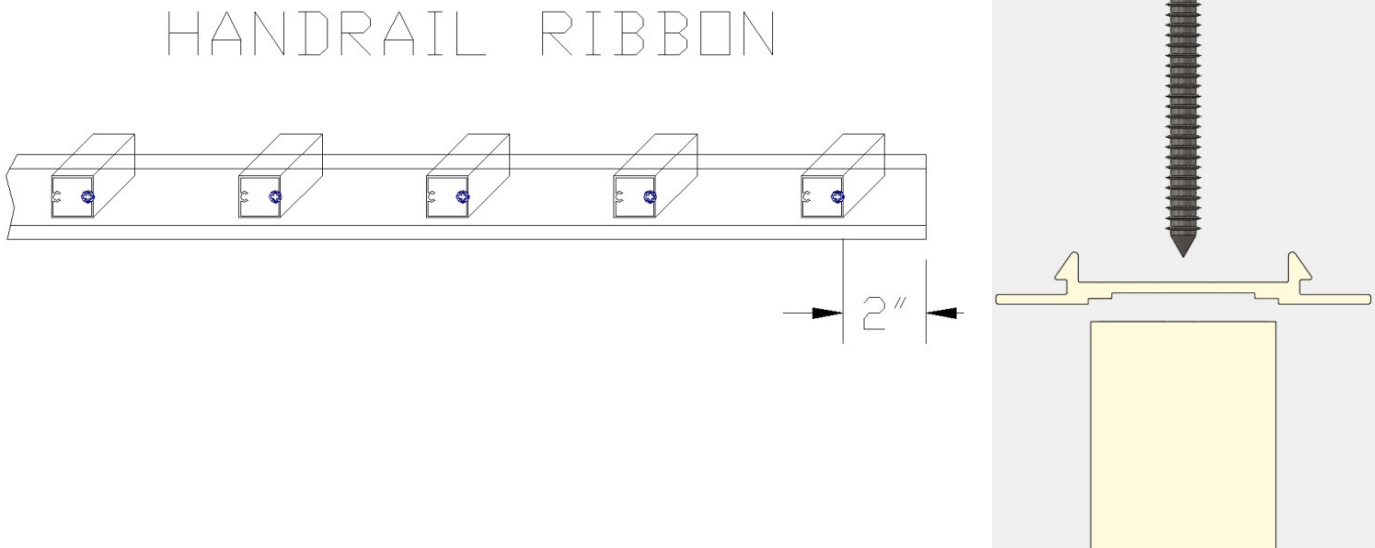

3. Attach the first baluster to the right end of the handrail (upper) ribbon with one screw only as illustrated below (#10x1-3/4" Flat Head). Note that the screw must be fastened into the right hand screw hole of each baluster. When using a power screwdriver, adjust the torque setting to a lower value to prevent damage to the screw head or baluster. If you do strip the baluster hole, you can turn the baluster 180 degrees and use the opposite hole.



4. Verify the distance from the outside edge of the first baluster to the right edge of the handrail ribbon as illustrated above. It should measure 2".
5. Attach the remaining balusters in order from right to left fastening the balusters to the handrail ribbon with one screw in each baluster.
6. Verify placement of attached baluster. There should be a 3.5" gap between each baluster.
7. Flip the assembly end-over-end so that the hand rail ribbon is now furthest away from you.

8. Fasten the bottom rail ribbon to each baluster from right to left as illustrated below. Note that the screw (#10x1-3/4" Flat Head) must not be installed in line with the first screw that was previously installed through the handrail (upper) ribbon. Mounting the balusters utilizing the two different holes will help to prevent the baluster from rotating.

BOTTOM RIBBON

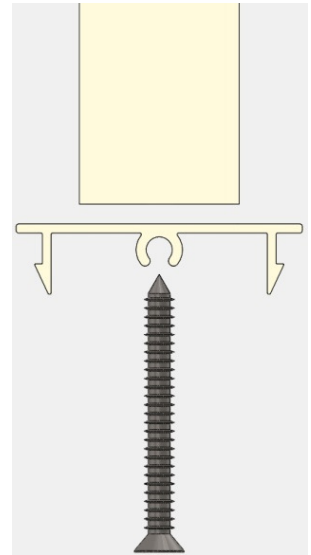
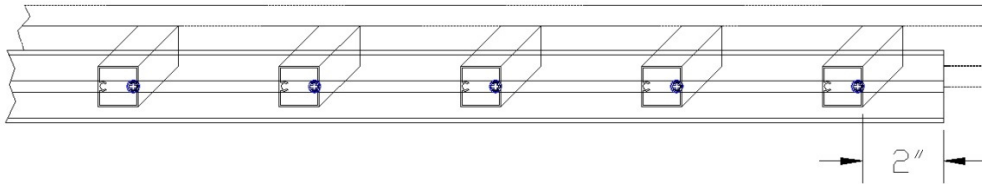

9. Attach the bottom cap to the bottom rail ribbon. Starting on one end, firmly squeeze the cap and the ribbon together until the cap starts to snap on. Continue squeezing the cap to the ribbon from one end to the other until the cap is completely attached to the ribbon. **Important:** The bottom rail cap should be attached prior to the hand rail cap.

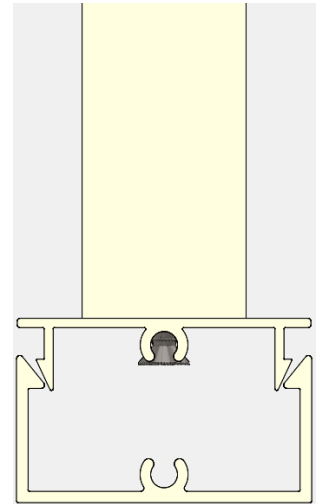

10. Repeat procedure in step 9 to attach the handrail cap to the hand rail ribbon. Do not attach the handrail cap until the bottom rail cap is securely attached.

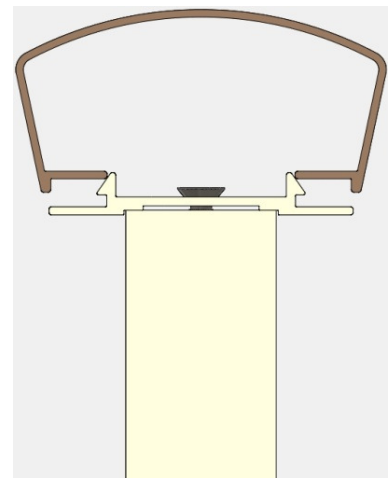

11. Mark the rail mount locations on the 3x3 rail posts according to the drawings below. Fasten the rail mounts to the 3x3 rail posts using the painted self-drilling Torx screws.

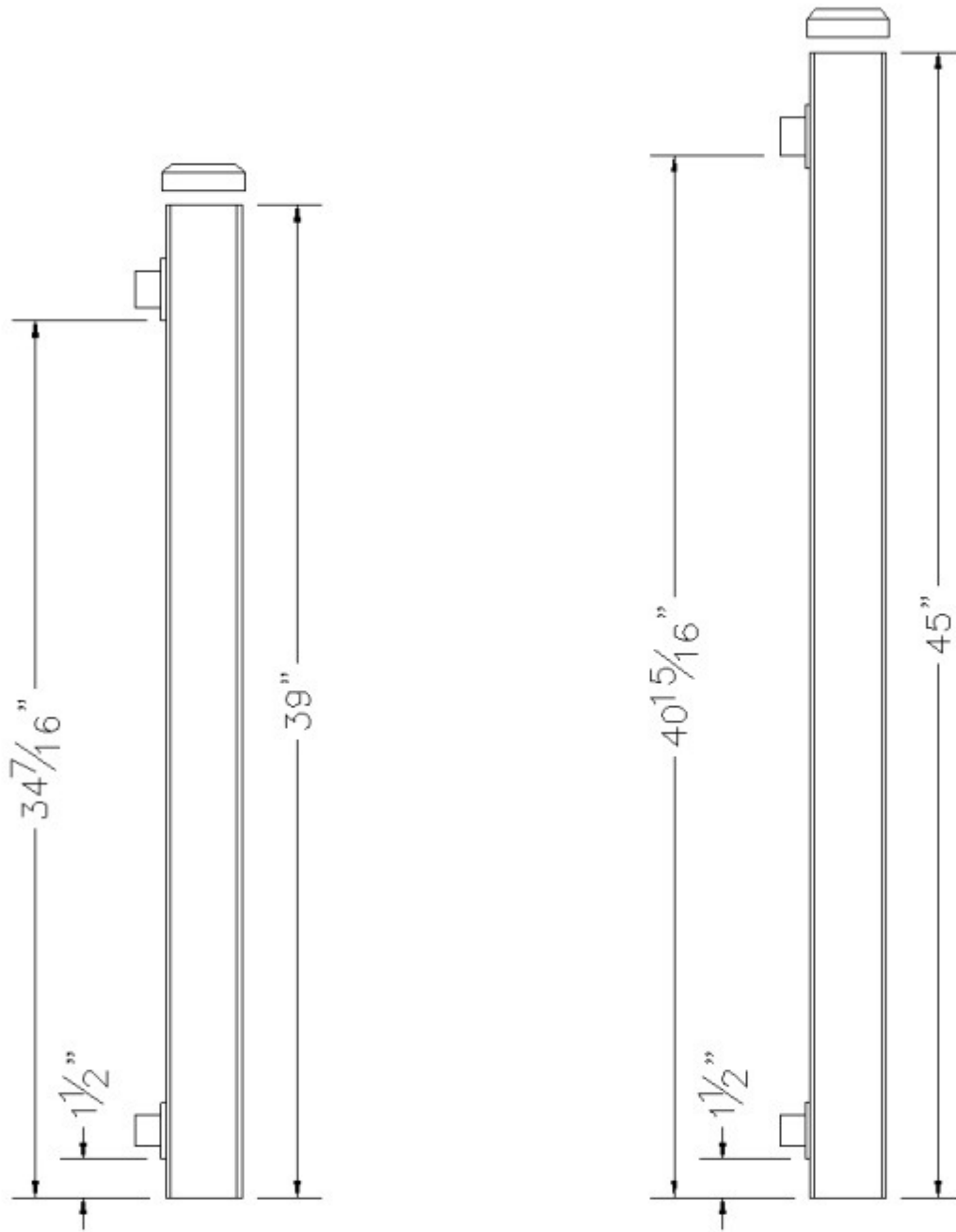

36" RAIL POST

42" RAIL POST

Proper Rail Mount Locations for 36" and 42" Rail Systems

This concludes the **Rail Section Assembly Guide**. For instructions on mounting your rail, refer to the rail mounting guide.